



NOTICE TO ALL FIRMS

Date: April 14, 2025
To: All Prospective Bidders
From: Maria De Los Angeles Lopez
Purchasing Agent
Re: Addendum Number 1
IFB # C1680 – Nagler Residence Hall Rooms and Corridors Painting, Floors 6-10

Notes:

- 1) A paint product on this project has been discontinued. Please find the updated A-800 Drawing attached.

THIS ADDENDUM IS PART OF THE CONTRACT DOCUMENT AND SHALL BE INCLUDED WITH YOUR REQUEST FOR PROPOSAL SUBMITTAL. YOUR SIGNATURE BELOW WARRANTS THAT YOU UNDERSTAND THIS ADDENDUM AND THAT YOU HAVE MADE THE APPROPRIATE ADJUSTMENTS IN YOUR PROPOSAL AND CALCULATIONS.

Signature

Print Name and Title of Authorized Representative

Print Name of Company/Partnership/Individual

Date

C1680 – Addendum No. 1

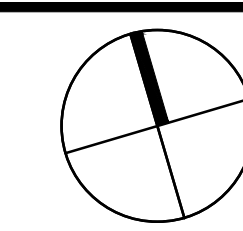

rev. no. date revisions
 4/9/2025 ADDENDUM #1

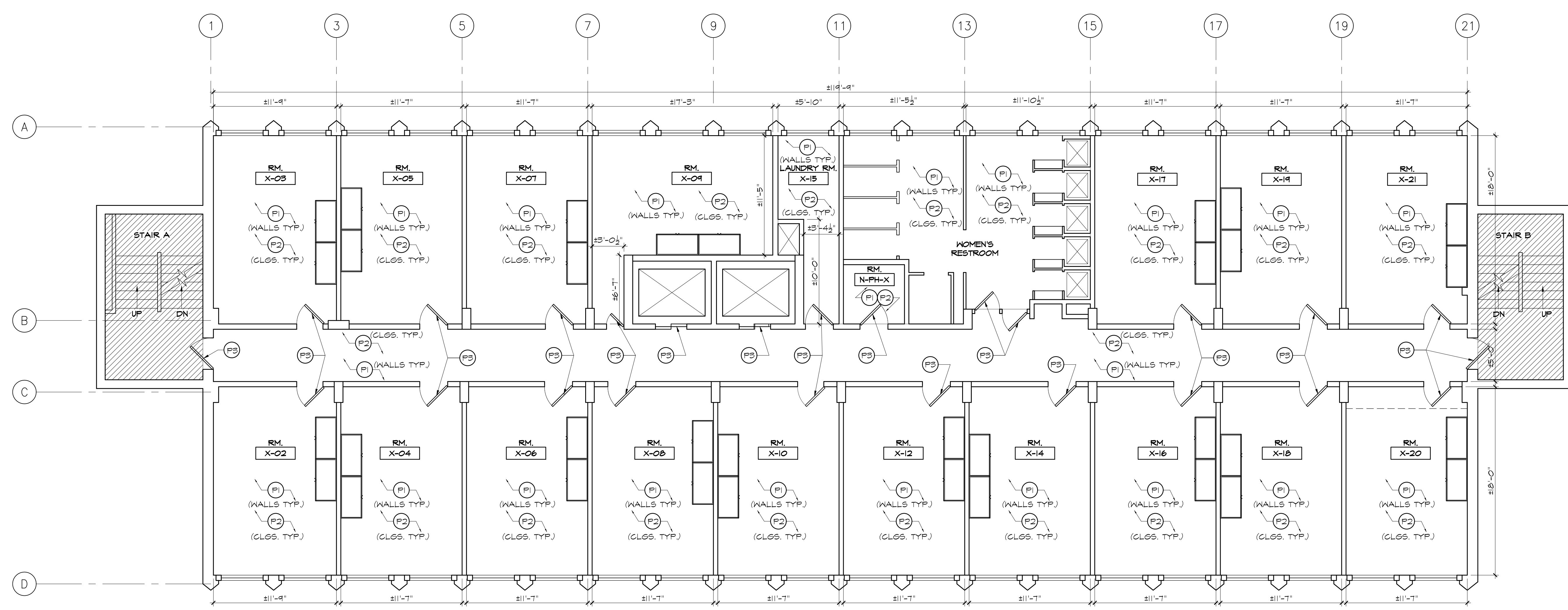
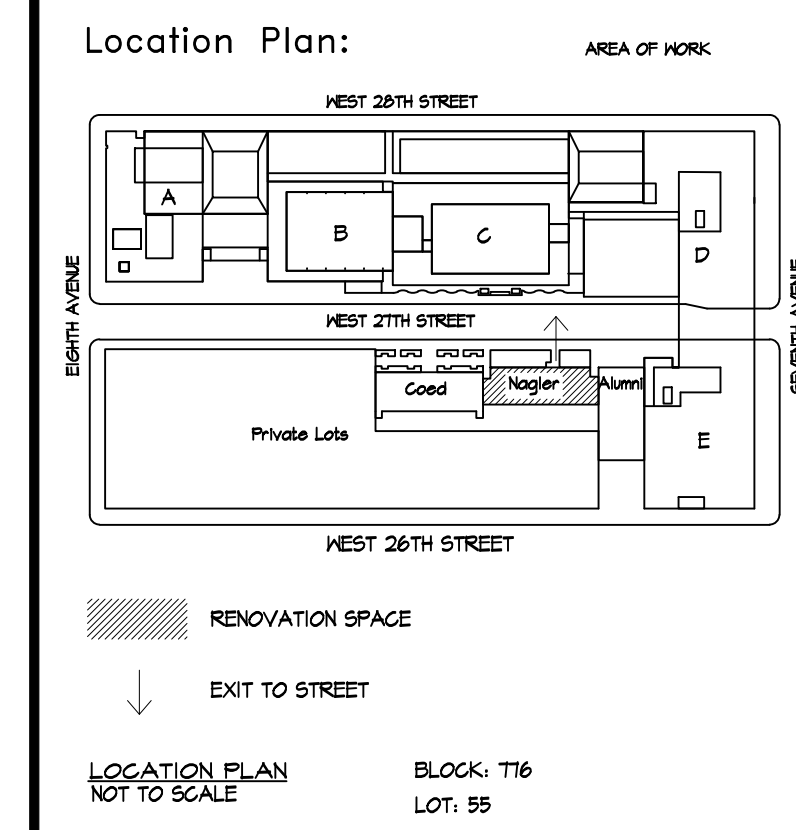

1 TYPICAL FINISH PLAN FLOORS 6 - 10
 A-800 SCALE: 3/16" = 1'-0"

Finish Legend	
PAINT	
(P1)	MFR: BENJAMIN MOORE COLOR: DECORATOR'S WHITE COLOR NO: 0C 149 FINISH: SEMI-GLOSS WALLS
(P2)	MFR: BENJAMIN MOORE COLOR: OXFORD WHITE COLOR NO: 869 FINISH: SEMI-GLOSS CEILING
(P3)	MFR: BENJAMIN MOORE COLOR: RIVER REFLECTION COLOR NO: 1552 FINISH: SEMI-GLOSS ENAMEL DOORS, FRAMES, CLOSETS

- Notes
- PREP ALL SURFACES AS PER MFR INSTRUCTIONS.
 - ALL EXISTING CORRIDOR DOORS AND FRAMES FLOOR TO BE PAINTED (P3) ON BOTH SIDES (TYP.)
 - ALL EXISTING ELEVATOR DOORS AND FRAMES TO BE PAINTED (P3)
 - ALL CEILINGS TO BE PAINTED (P2) AS NOTED.
 - ALL WALLS TO BE PAINTED (P1).
 - TYPICAL CEILING HEIGHTS RANGE FROM 8'-0" - 8'-3".
 - ALL EXPOSED PIPING, CONDUITS & SURFACE MOUNTED RACEWAYS ON WALLS & CEILINGS TO BE PAINTED TO MATCH WALLS (P1).
 - CONTRACTOR TO SUBMIT COLOR SAMPLES AND PRODUCT DATA.
 - ALL EXISTING HVAC DIFFUSERS & GRILLES TO BE CLEANED.
 - EXISTING WARDROBES ARE 8'X2'X7' (WxDxH) AND ARE BOLTED TO THE WALLS. WARDROBES ARE TO REMAIN IN PLACE AND ARE TO BE PAINTED AROUND. PROVIDE PROTECTION AS REQUIRED.
 - IF PAINTING MUST BE DONE IN HOT CONDITIONS, THE ADHERENCE OF THE PAINT MAY BE PROBLEMATIC. USE BENJAMIN MOORE EXTENDER 518 IF REQUIRED TO ALLOW FOR PROPER ADHERENCE.

LEGEND	
---	EXISTING GNB SOFFIT ABOVE
▨	N.I.C.

NOTE:
 BUILDING DOES NOT HAVE AIR CONDITIONING.

Fashion Institute of Technology
 STUDENT HOUSING CORPORATION
 230 WEST 27TH ST
 NEW YORK, NY 10001

David Smotrich & Partners LLP
 Architects/Planners

443 Park Avenue South New York, NY 10016
 212 889 4045 Fax 212 889 3672

PROJECT:
 NAGLER RESIDENCE HALL
 ROOMS & CORRIDORS PAINTING
 FLOORS 6-10
 220 W 27TH ST
 NEW YORK, NY 10001

DRAWING TITLE:
 TYPICAL FINISH PLAN -
 FLOORS 6 - 10

SEAL & SIGNATURE:	DATE: 03/28/2025
	PROJECT No: C1680
	DRAWING BY: KM
	CHK BY: DH/CK
	DWG No:
	A-800.00
	SCALE: 3/16"=1'-0" 3 of 3